

Leviat[®]
A CRH COMPANY



MASONRY TO MASONRY
WALL TIES



WALL STARTER
SYSTEMS



MASONRY TO TIMBER
WALL TIES



MASONRY TO STEEL
WALL TIES



OTHER MASONRY
PRODUCTS



ROOFING
PRODUCTS

Ancon[®]

Staifix Wall Ties & Restraint Fixings



We are one team. **We are Leviat.**

Leviat is the new name of CRH's construction accessories companies worldwide.

Under the Leviat brand, we have united the expertise, skills and resources of Ancon and its sister companies to create a world leader in fixing, connecting and anchoring technology.

The products you know and trust will remain an integral part of Leviat's comprehensive brand and product portfolio. As Leviat, we can offer you an extended range of specialist products and services, greater technical expertise, a larger and more agile supply chain and better, faster innovation.

By bringing together CRH's construction accessories family as one global organisation, we are better equipped to meet the needs of our customers, and the demands of construction projects, of any scale, anywhere in the world.

This is an exciting change. Join us on our journey.

Read more about Leviat at Leviat.com



Our product brands include:

Ancon[®]

HALFEN

HELIFIX

ISEDIO[®]

PLAKA



60

locations

sales in
30+
countries

3000
people worldwide

Imagine. Model. Make.

Leviat.com

Logo Guide

Look out for these logos.



These products are supplied with a UKCA and

CE or CE UKNI marking. Please see table on page 32 to find the relevant approvals for each product.



These products are approved by the British Board of Agrément.



These products are Type A ties and suitable for internal separating walls to Approved Document E.

Availability

Ancon and Ancon Staifix Wall Ties are available from builders merchants and other specialist distributors throughout the UK. For details of your nearest stockist please contact us on 0114 238 1 238.

Correct Installation

Wall ties should be pressed down in, and then surrounded by, fresh mortar. In order to show more details of the application, mortar has been excluded from the photography in this literature.



Masonry to Masonry Wall Ties

Pages 4-11

- Ancon Staifix Wall Ties
- Ancon Wall Ties
- Ancon Teplo Wall Ties
- Ancon Staifix-Thor Helical Wall Ties
- Other Standard Restraint Fixings



MASONRY TO MASONRY
WALL TIES

Wall Starter Systems

Pages 12-15

- Ancon Staifix Universal Wall Starter System
- Ancon Staifix Starter Tie
- Ancon Staifix Cavity Starter Tie

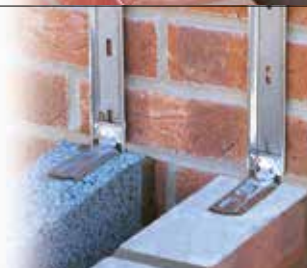

WALL STARTER
SYSTEMS

Masonry to Timber Wall Ties

Pages 16-19

- Ancon Staifix Timber Frame Tie
- Ancon Staifix-Thor Helical Timber Tie
- Ancon Teplo-L-Tie
- Ancon Staifix Frame Tie



MASONRY TO TIMBER
WALL TIES

Masonry to Steel Wall Ties

Pages 20-21

- Ancon 25/14 Restraint System



MASONRY TO STEEL
WALL TIES

Other Masonry Products

Pages 22-28

- Ancon AMR Masonry Reinforcement
- Ancon Staifix Insulated Plasterboard Nails
- Ancon Staifix-Thor Helical Crack Stitching Kit
- Remedial Wall Ties



OTHER MASONRY
PRODUCTS

Roofing Products

Pages 29-31

- Wire Balloons
- Super-7 Thor-Helical Nail for Pitched Roofs
- Super-8 Headed Helical Nail for Flat Roofs



ROOFING
PRODUCTS

Stainless Steel Cavity Wall Ties

for traditional masonry construction with cavities from 50mm to 225mm



Ancon Staifix Universal Insulation Retaining Clip (Uni Clip)

For use with standard Ancon/Ancon Staifix stainless steel ties in partial fill cavities

Application

These stainless steel wall ties connect the two leaves of a cavity wall. Product selection is based on building type and height, geographical location and cavity width. Specially designed safety ends reduce the risk of injury during handling and installation.



Ancon Staifix HRT4 Light Duty Tie

(Type 4 Tie to PD6697)

Length (mm)	Cavity (mm)
200	50-75
225	76-100
250	101-125
275	126-150

Type 4 wall tie for use in the external walls of houses up to 10 metres in height. Altitude and wind speed restrictions may apply.

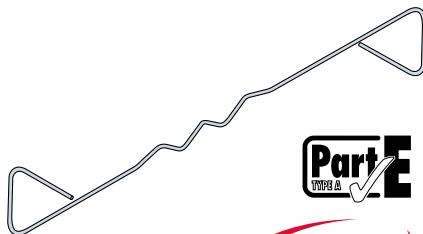

Available in packs of 20 or 250

Ancon Staifix RT2 General Purpose Tie

(Type 2 Tie to PD6697)

Length (mm)	Cavity (mm)
200	50-75
225	76-100
250	101-125
275	126-150

Type 2 wall tie for use in the external walls of houses and small commercial developments up to 15 metres in height. Altitude and wind speed restrictions may apply.

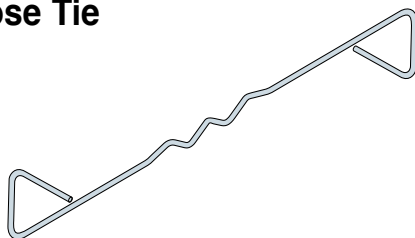

Available in packs of 20 or 250

Ancon ST1 Heavy Duty Tie

(Type 1 Tie to PD6697 in M2 mortar)

Length (mm)	Cavity (mm)
200	50-75
225	76-100
250	101-125
275	126-150
300	151-175
325	176-200
350	201-225

Type 1 wall tie for use in the external walls of buildings of any height anywhere in the British Isles.

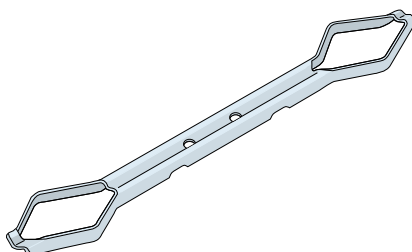

Available in packs of 250

Note: For internal separating walls of new-build attached dwellings use HRT4 only. Check product packaging or contact us for more information.

Ancon Teplo Basalt Fibre Wall Ties

for ultra energy-efficient buildings with cavities up to 450mm



Teplo-Clip

Insulation retaining clip
for use with all Ancon Teplo wall ties

Teplo-L-Tie

Features a stainless steel
upstand for surface fixing

Teplo-BFR

Features a plain end
for resin anchoring to
existing structure

Teplo-BF

Cavity wall tie with
rounded safety ends

Application

Ancon Teplo wall ties are manufactured from pultruded basalt fibres set in a resin matrix. They have a thermal conductivity of just 0.7W/mK and are shown in U-value calculations to reduce insulation thickness and wall footprint.



Teplo-BF-CT

For use with our popular
Omega 21/18, 25/14 and
28/15 channel profiles.

Ancon Teplo-BF4 (Type 4 Tie to PD6697)

Length (mm)	Cavity (mm)
200	50-75
225	76-100
250	101-125
550	401-425
575	426-450



Type 4 wall tie for use in external walls of houses up to 10 metres in height. Altitude and wind speed restrictions may apply.

Ancon Teplo-BF3 (Type 3 Tie to PD6697)

Length (mm)	Cavity (mm)
450	301-325
475	326-350
500	351-375
525	376-400



Type 3 wall tie for use in external walls of houses and small commercial developments up to 15 metres in height. Altitude and wind speed restrictions may apply.

Ancon Teplo-BF2 (Type 2 Tie to PD6697)

Length (mm)	Cavity (mm)
200	50-75
225	76-100
250	101-125
275	126-150
300	151-175
325	176-200
350	201-225
375	226-250
400	251-275
425	276-300



Type 2 wall tie for use in external walls of houses and small commercial developments up to 15 metres in height. Altitude and wind speed restrictions may apply.

Ancon Teplo-BF1 (Type 1 Tie to PD6697)

Length (mm)	Cavity (mm)
200	50-75
225	76-100
250	101-125
275	126-150



Type 1 wall tie for use in the external walls of buildings of any height anywhere in the British Isles.

Note: These ties are unsuitable for internal separating walls to Approved Document E (use HRT4 on page 5).

Ancon Staifix-Thor Helical TJ2 Tie

for thin-joint blockwork



Length (mm)	Cavity (mm)
205	50
230	75
255	100
280	125
305	150

Application

Hammer-driven cavity wall tie, ideal for thin-joint blockwork and other applications where the joints of the inner and outer leaves of masonry do not course. Suitable for buildings up to 15 metres in height when used with high strength blocks. Contact us for more details.

For thin-joint to thin-joint separating walls use the Ancon Staifix HRT4 (see page 5).

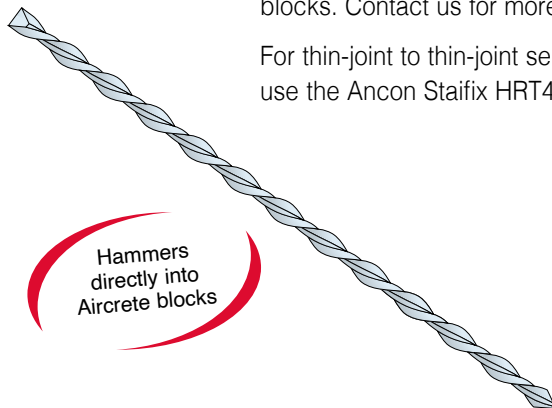

European Patent No. 1307303

Installation

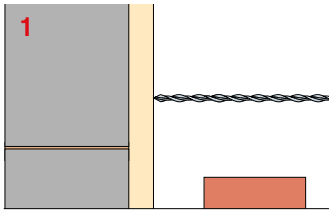

Keep the brickwork one course clear during installation of the ties. Position the tie against the inner leaf so that the outer end will be located in the bed joint of the external leaf.

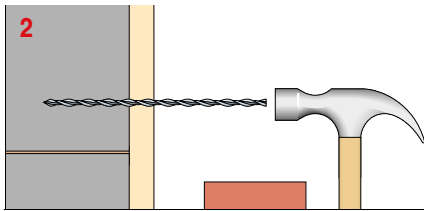

Hammer the tie, through the insulation, and into the blockwork to the correct embedment.

Support tools are available to simplify installation.

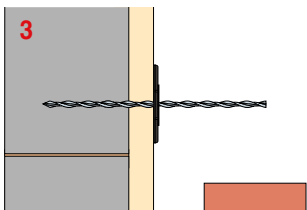

Install a black Teplo Insulation Retaining Clip to restrain the insulation.

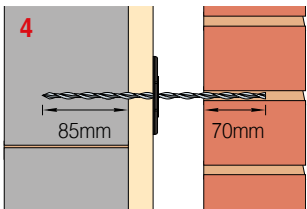

Build into the bed joint of the outer leaf ensuring the tie is surrounded by mortar.

Embedment

Staifix-Thor Helical TJ2 Thin-Joint Ties should have a minimum embedment of 85mm in the inner leaf of blockwork and 70mm in the outer leaf of brickwork.

Other Standard Ancon Wall Ties

lengths shown in *red italics* refer to items available within 24 hours

Ancon Teplo-L-Tie

Low thermal conductivity restraint fixing



Lengths *165, 190, 215, 240, 265, 290, 315, 340, 365mm*

Application

Basalt fibre frame cramp with stainless steel upstand, used to join masonry to existing structures.



Ancon PPS Movement Tie

For vertical movement joints



Lengths 175, *225, 250*, 275, 300mm

Application

Flat tie used with a debonding sleeve to allow the masonry to expand or contract.

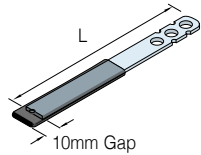

DT Double Triangle

Lengths *150*, 200*, 225**, *250**, 300mm***

*Conforms to PD6697 as a Type 2 tie
**Type 3 tie

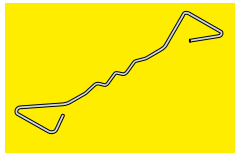

RD3

Lengths *250, 275mm*
Conforms to PD6697 as a Type 3 tie

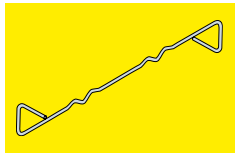

HRD4

Lengths *250, 275mm*
Conforms to PD6697 as a Type 4 tie

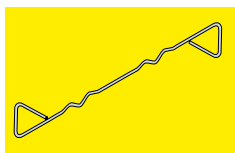

SPS

Lengths *150, 200, 225, 250, 275, 300mm*

SPS CJ

Lengths *150mm*
(3mm thickness for collar-jointed construction)

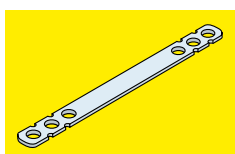

SPB

Lengths 75, *100, 125, 150, 175, 200, 225, 250, 275, 300mm*
(Heavy duty version also available)

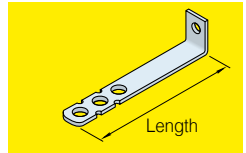

SDB

Lengths *125, 150, 175, 200, 225*, 250, 275, 300mm

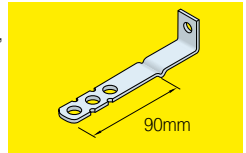

SDV

Lengths *125, 150, 175, 200, 225, 250, 275, 300mm*

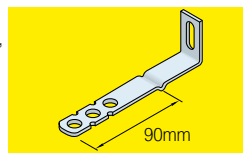

PPB

Lengths *125, 150, 175, 200, 225mm*

PPV

Lengths *125, 150, 175, 200, 225mm*

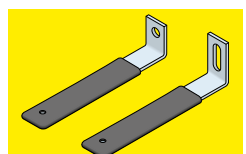

Wall Tie Installation

Symmetrical Ancon wall ties (HRT4, RT2, ST1 and Teplo-BF) accommodate some site tolerance in their length, for both cavity width variation and centring of the tie. In line with PD6697: 2010 and Approved Document A, the minimum wall tie embedment is 50mm. Longer wall ties will be required where cavities are outside the tolerance offered.

For walls in which both leaves are 90mm or thicker, ties should be installed at not less than 2.5 per square metre (900mm x 450mm vertical centres).

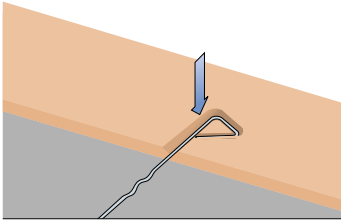

Wall ties should be pressed down in, and then surrounded by, fresh mortar. Symmetrical wall ties should be centred from the middle of the cavity to ensure equal embedment in each leaf.

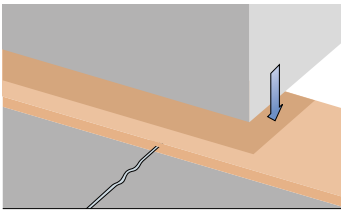

To ensure cavity wall ties are effective at tying the leaves together they should be installed as the inner leaf is constructed and not simply pushed into a joint.

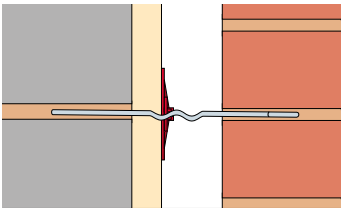

Ties should be installed level or with a slight fall to the outer leaf, never towards the inner leaf as this could provide a path for moisture to cross the cavity.

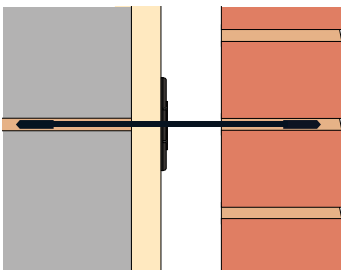

Installed ties should be clear of mortar droppings to allow the drip to function and prevent water from crossing to the inner leaf of masonry.

Ancon Staifix Universal Wall Starter System

for joining new walls to existing masonry



Application

Wall starter system with all the necessary fixings to join a single skin of masonry 2.4 metres high to an existing wall.

Suitable for:

- Brickwork and blockwork
- Imperial and metric masonry units
- Single leaf and cavity walls
- Internal and external use
- Wall widths from 60mm to 250mm
- Masonry up to 8 metres in height

Wall ties slide within the fixing strip to course with the bed joints of any masonry unit.

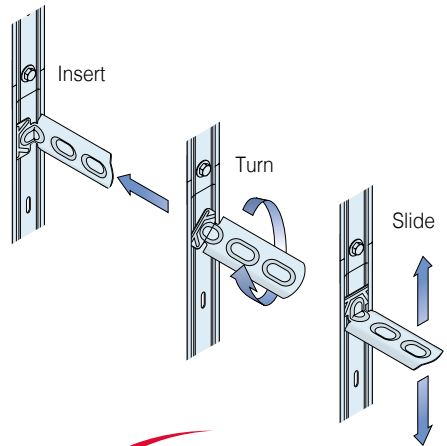

Ideal for conservatories, extensions and garden walls

Universal Wall Starter Installation

Prior to installation remove any render, debris etc from the existing wall where the new wall will be joined.

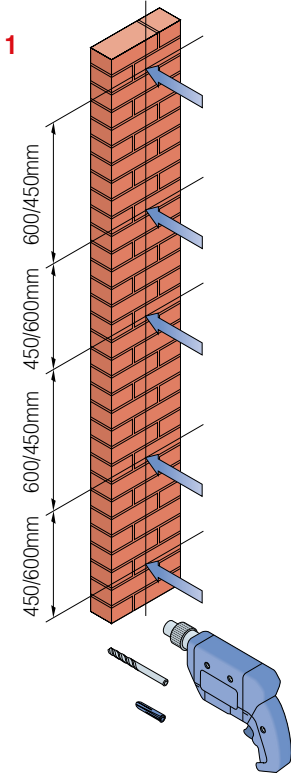

- Mark the position of the five fixing holes so that the Wall Starter System will be central to the new wall. When overlapped, the strips should be fixed through the first and last slot, at the point of overlap and at two other points in between (alternate 450mm and 600mm centres are recommended).
- Drill 10mm diameter holes and install wall plugs.

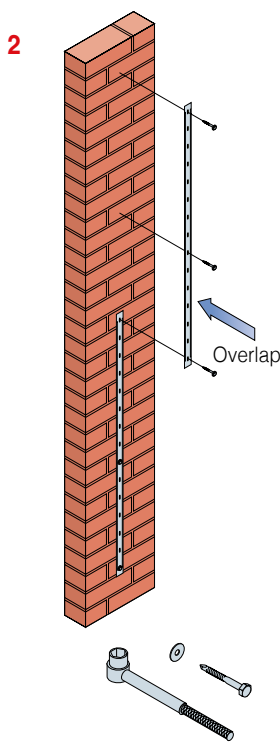

- Loosely fix first strip at the bottom two fixing points.
- Insert second strip into the top of the first strip and loosely fix at the remaining three fixing points.
- Fully tighten screws, in any order, when both strips are in position.

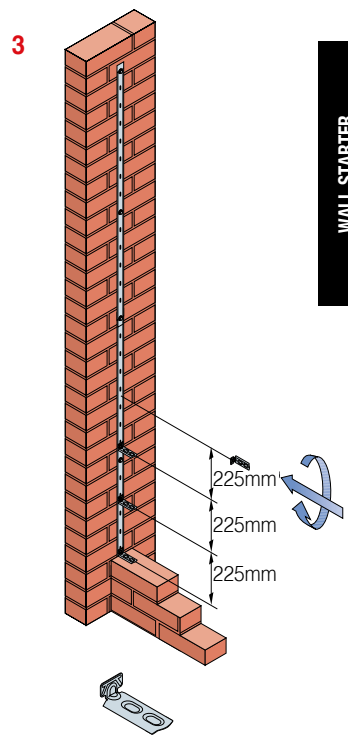

- Insert wall ties by turning 90° clockwise in the fixing strip and build into the bed joints of the new wall, ensuring they are surrounded by mortar (225mm vertical centres are recommended).

Ancon Staifix Starter Ties

for joining new walls to existing masonry

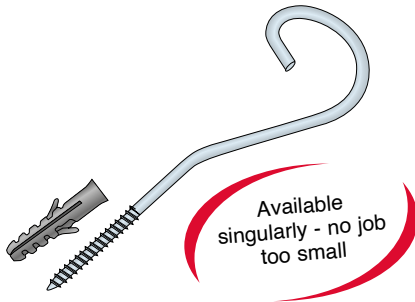

Wall Starter Tie

Screw-in tie supplied with an 8mm nylon plug for joining new masonry to existing walls without the need for jointing.

Ideal for the construction of conservatories, extensions and garden walls.

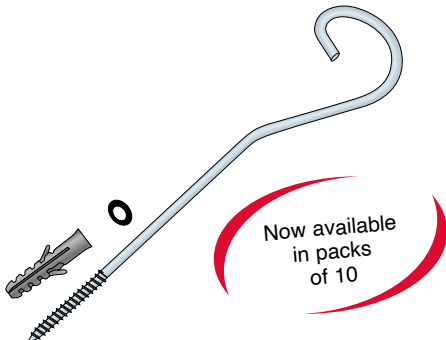

Cavity Starter Tie

Screw-in tie that simplifies the build of an inner leaf of blockwork within an existing structure. Supplied with an 8mm nylon plug and a neoprene 'o' ring.

Length (mm)	Cavity (mm)
180	50-70
200	75-95
230	100-120

Note: Embedment depth for above tie lengths should be 65-85mm in mortar joint.

Ancon Staifix Wall Starter Tie Installation

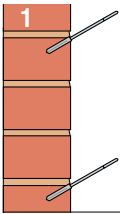

Starter Ties should be fixed at 225mm vertical centres in a line central to the new leaf. Drill 8mm diameter holes, 45mm deep into the existing wall at an angle of 30° to the horizontal. Insert wall plugs provided and screw in ties.

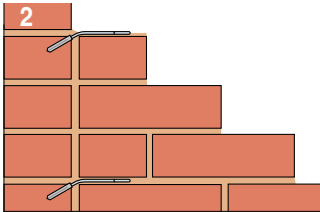

Bend the tie into the bed joint of the new brickwork. Build the tie in ensuring it is surrounded by mortar.

This tie is suitable for use in masonry up to 8 metres in height. For buildings in particularly exposed areas, especially if the wall is higher than 5 metres or the construction is single leaf, it would be advisable to carry out a check calculation using the wind code and increase the density of starter ties if necessary.

Ancon Staifix Cavity Starter Tie Installation

1

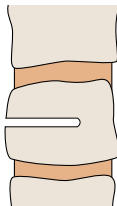

Drill an 8mm diameter hole horizontally into existing outer leaf of masonry. Position the hole such that when the tie is installed the safety end will be located in the bed joint of the new inner leaf of blockwork.

2

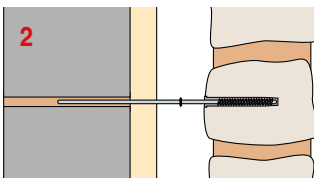

Insert the nylon plug. Slide the neoprene 'o' ring on the tie and screw into the plug. Build the tie into the inner leaf of blockwork ensuring it is surrounded by mortar.

Ancon Staifix Timber Frame Ties

for fixing masonry to timber frames up to four storeys in height

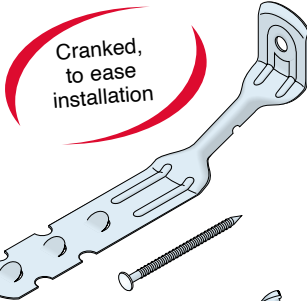

STF6 Timber Frame Tie

Cranked cavity wall tie for use in the construction of timber-framed buildings. Supplied complete with an annular ring shank nail. Available in three lengths to suit cavities of 50, 75 and 100mm.

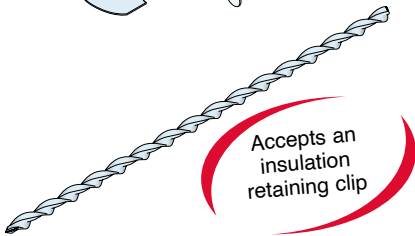

TIM6 Helical Timber Frame Tie

Hammers directly into timber frames without a pilot hole, through insulation where necessary. Available in four lengths to suit cavities from 50mm to 150mm.

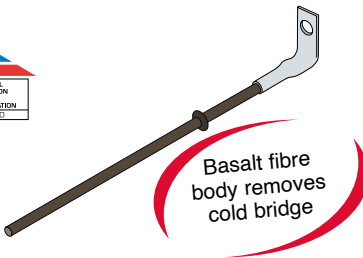

Ancon Teplo-L-Tie

For applications where a low thermal conductivity restraint fixing is required between masonry and a timber frame. Available in 9 lengths to suit cavities from 100mm to 300mm.

STF6 Installation

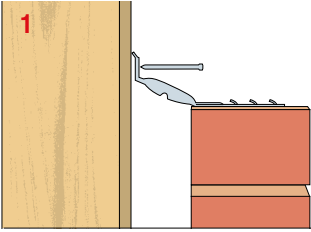

Position the tie on fresh mortar in the bed joint of the outer leaf of masonry with the upstand against the timber.

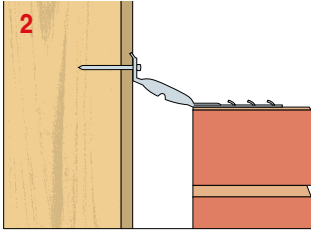

Hammer the nail, through the hole in the upstand, into the timber framework.

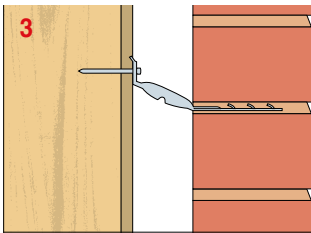

Build the tie into the bed joint of the new masonry ensuring it is surrounded by mortar.

Density of Timber Frame Ties

Timber Frame Ties should be installed at a density of 4.4 ties per square metre in buildings where the basic wind speed does not exceed 25m/s (BS6399-2: 1997 Code of Practice for Wind Loads). The density should be increased to 7 ties per square metre in more severe situations.

TIM6 Installation

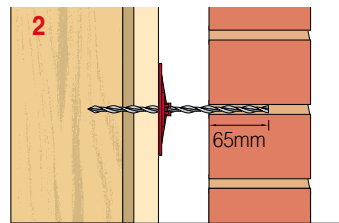
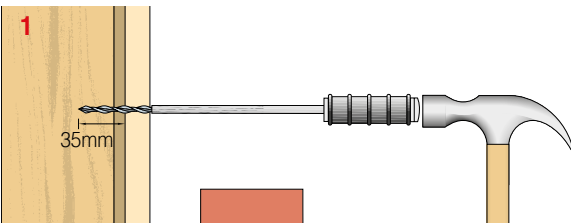

Ancon Staifix Frame Tie

for fixing timber door and window frames to brickwork



Application

Screw-in tie used to join timber door and window frames to brickwork.

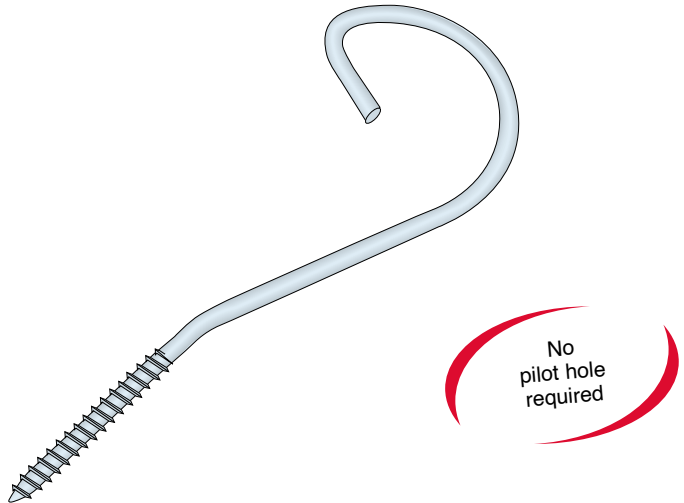

Installation

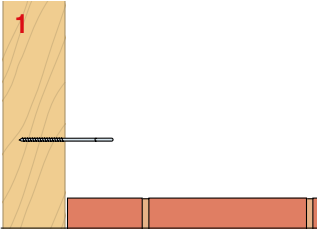

Screw the tie horizontally into the door or window frame at a bed joint position.

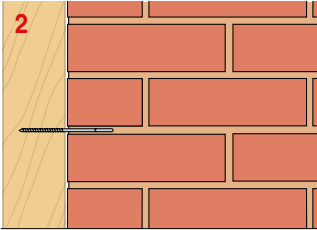

Build the tie into the bed joint of the new brickwork ensuring that it is surrounded by mortar.

The Ancon Staifix Frame Tie should not be used as a wall starter tie (see page 14).

Vertical spacing of Ancon Staifix Frame Ties

Width of Opening (mm)	Required Vertical Spacing Modified for Coursing (mm)
<1001	300
1001-1400	225
1401-2100	150
>2100	75

Suitable for buildings up to 15m in height on flat sites where the basic wind speed does not exceed 31m/s.

Ancon 25/14 Restraint System

for tying masonry to steel, concrete or timber frames through any insulation type

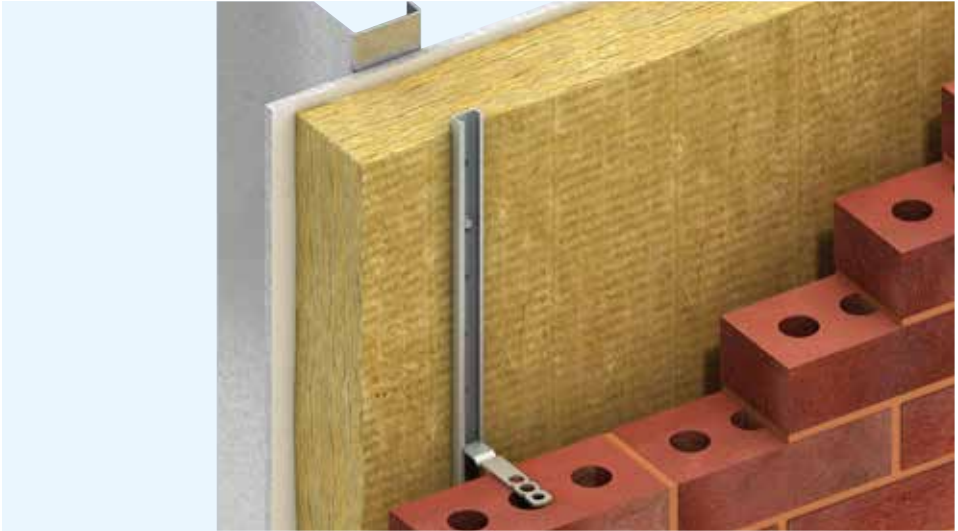

Tie Length (mm)	Open Cavity (mm)
100	35 - 59
125	60 - 84
150	85 - 109

Note: Other tie lengths to suit larger cavities are available.

Applications

Channel-and-tie system for fixing masonry to an in-situ structure through an insulation layer.

For fixing to steel or timber frames, Ancon self-drilling high-thread screws should be used through the channel and insulation and into the frame. They are suitable for an insulation depth up to 220mm.

For fixing to concrete, Ancon concrete fixing screws should be used through the channel and a stainless steel compression sleeve, located in the insulation, and into a pilot hole in the concrete. They are suitable for an insulation depth up to 267mm.

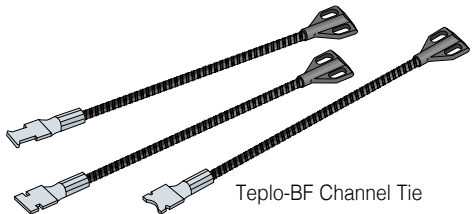
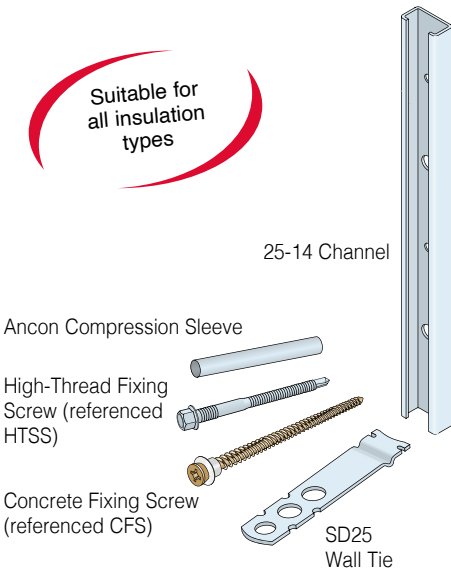

Installation (shown with rigid insulation and a steel frame)

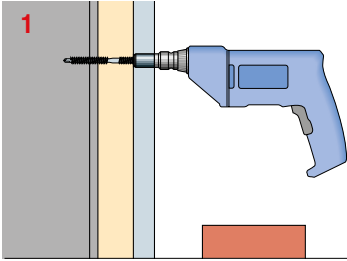

Fix channel to steel frame with Ancon self-drilling screws. Contact us for fixing centres. Ancon 25/14 channel is supplied with pre-punched holes at close centres to ensure a fixing position is always located near the end when the channel is cut on site.

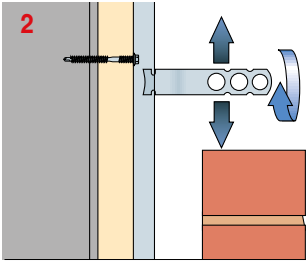

The spacing of ties is based on the height of the building and geographical location. Contact us for details. SD25 or Teplo-BF-CT 25 wall ties can be positioned at any point along the channel's length. Ties should achieve a minimum embedment of 50mm in the outer leaf and be pressed down in fresh mortar.

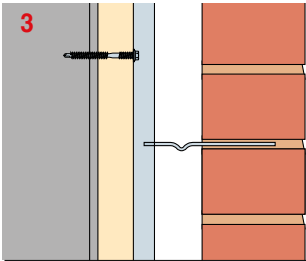

Build the tie into the bed joint of the new masonry ensuring it is surrounded by mortar.

Notes: Screws are available in various lengths to accommodate an insulation thickness of up to 220mm. SD25 wall ties are available in lengths from 100mm to 300mm to suit open cavities up to 259mm. Teplo-BF-CT 25 wall ties are available in lengths from 150mm to 375mm to suit open cavities up to 334mm. Contact us for installation details for other frame and insulation types.

Ancon AMR Masonry Reinforcement

to strengthen masonry panels



AMR Width	Wall Thickness
60mm	100-125mm Brick/Block
100mm	140-150mm Block
150mm	190-200mm Block
175mm	215mm Block

AMR Applications

Stainless steel reinforcement, installed in a bed joint to strengthen masonry walls. Manufactured in lengths of 2700mm.

Available in five wire diameters and four widths, AMR suits the majority of wall conditions.

For collar-jointed walls use Ancon AMR-CJ.

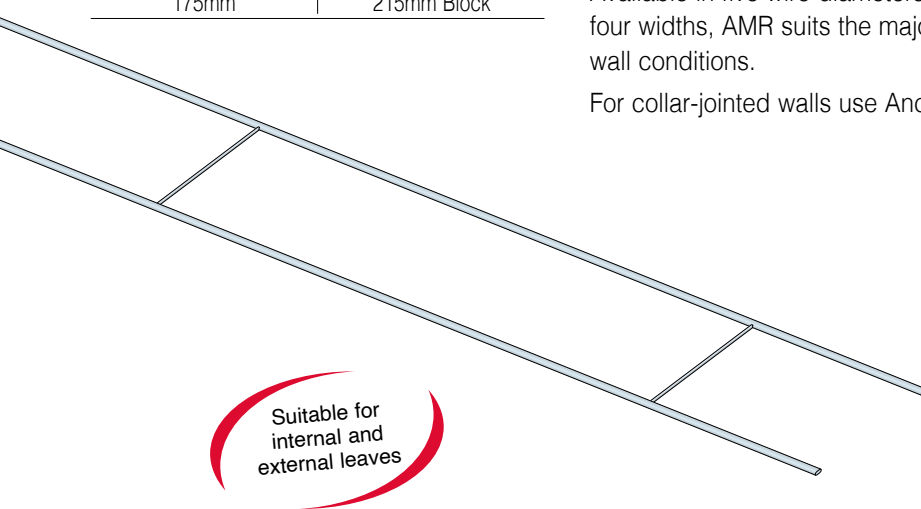

Suitable for
internal and
external leaves

Laps and Positioning

The position of laps should be staggered throughout the masonry panel.

Laps should be a minimum of 225mm in length and include one cross wire. Laps can be achieved by either stacking the product or positioning lengths side by side.

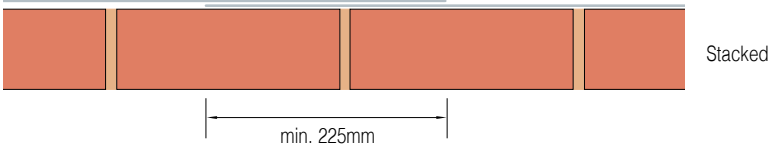
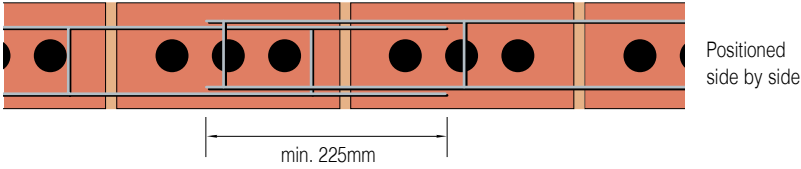

Note: Overall thickness of AMR when stacked is less than 6mm.

Corners

Prefabricated corner units can be manufactured to provide true continuity of reinforcement. Alternatively, Ancon AMR can be cut and bent on site.

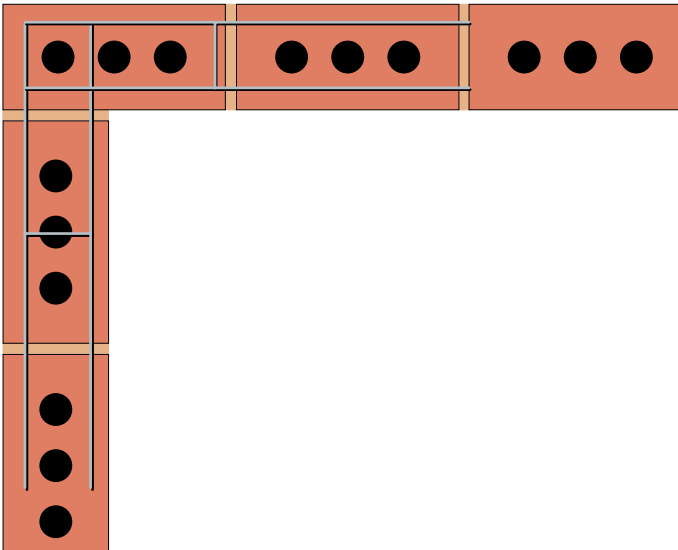

Insulated Plasterboard Nails

Fire-proof steel fixing for securing insulated plasterboards



Available Lengths

65, 85, 105, 125, 145mm

Application

A one piece steel fastener (referenced ISF18A) with a dish-profiled head for mechanically securing drywall and insulated plasterboard panels to walls.

This fire-proof steel fastener has a self-tapping helical shank with work-hardened blades that cut into a wide range of masonry and timber substrates.

Available
in packs
of 20



Installation

The fixings are driven-in by an adaptor, which is powered by a standard SDS hammer drill.

The anchor drives directly into aircrete blocks and softwood timber. A 5mm pilot hole is recommended for brick, concrete block and hardwood.

A 6mm pilot hole is required for structural concrete and engineered brick.

Substrate	Embedment depth
Aircrete Block	50-75mm
Brick/Concrete Block	40-60mm
Softwood	35-50mm



Standard SDS Adaptor

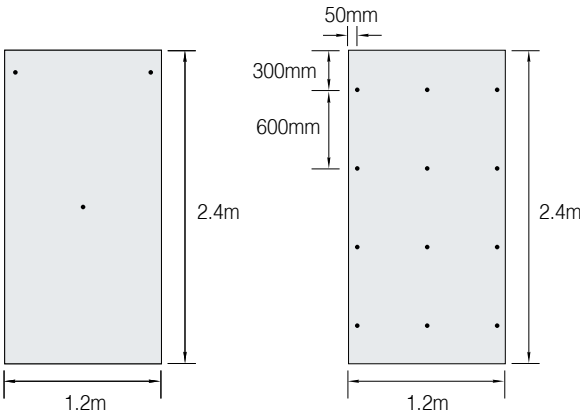

• = Position of fixing
If used with 'dot and dab' method

• = Position of fixing
If used instead of 'dot and dab' method



Professional SDS Adaptor Set

3 fixings are required per panel if used with 'dot and dab' method. Each dab should be 50mm to 75mm wide and approx. 250mm long.

12 fixings are required per panel if used instead of 'dot and dab'.

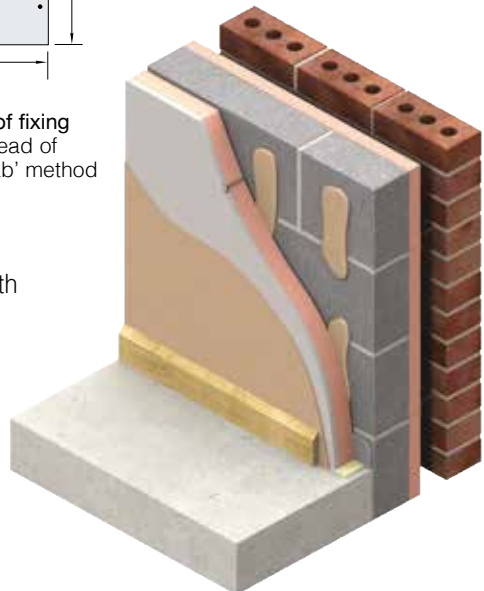

OTHER MASONRY PRODUCTS

Ancon Staifix-Thor Helical Crack Stitching Kit

for the permanent repair of cracked masonry

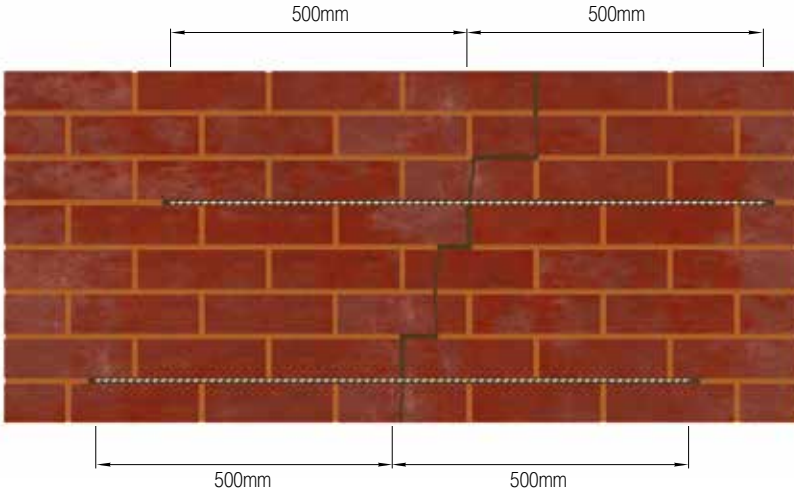

Wall Thickness	Slot Depth	Bar Depth
102mm	30mm	20mm
215mm	40mm	30mm

Application

This kit contains all the necessary components to permanently repair vertical or stepped cracks in masonry.

- Grout mixing paddle
- Cementitious grout (3 litres)
- Grout applicator gun with flat nozzle
- Ten stainless steel helical bars (6mm \varnothing x 1000mm)
- Finger trowel

The high strength, non-disruptive repair solution



Notes:

1. This system is also suitable for rendered/plastered walls
2. Vertical spacing is normally every 4 to 6 brick courses (300 - 450mm), however this should be checked with the structural engineer
3. Where cracks are within 500mm from corners or reveals, the bar should be bent and bonded 100mm around the corner
4. If two or more cracks are close together, bars can be lapped. Laps should be at least 500mm and the bar should extend 500mm from the outer cracks

Installation

It is essential that the cause of the cracking is established by a structural engineer and then eliminated, prior to the installation of this system.



Cut a slot in the mortar joint to the specified depth that extends just over 500mm each side of the crack (recommended equipment: Twin-bladed diamond-tipped wall chaser). Ensure the mortar is completely removed to reveal the top and bottom faces of the masonry. Remove all loose mortar from the slot and flush with clean water.



Connect the paddle to a power drill, blend the components of the grout together in the tub and load into the gun. Apply a continuous bead (approximately 10-15mm thick) to the back of the slot.



Push the helical bar into the face of the grout, to the depth specified, so that the bar extends 500mm each side of the crack.



Apply a second, continuous bead of grout to the slot, ensuring the bar is covered. With the finger trowel, force the grout back into the slot 10mm from the surface, and ensure the bar/grout composite is tightly packed.



Make good the bed joint and fill the vertical crack with an appropriate filler or mortar.

Ancon Remedial Wall Ties

Ancon MM63

Lengths **200, 225, 255**mm



Ancon AC 31C

Lengths 175, 200, 225mm



Ancon RM63

Lengths **200, 225, 250, 300**mm



Ancon Teplo-R

Lengths 215-590mm



Ancon Staifix R/R

Lengths 180, 200, 220mm

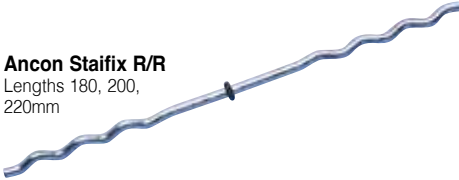

Ancon HRT4/R

Lengths 200, 225, 250mm



Ancon Stairib Bar

Length to order
6, 8mm dia.

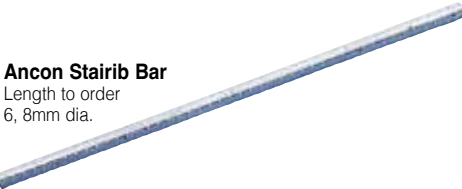

Ancon Type A R/R

Length 225mm

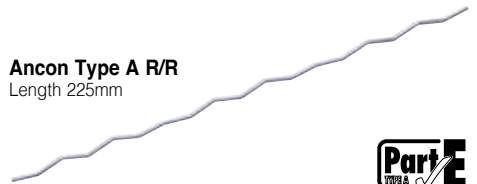

Ancon AC 31

Lengths 175, 200, 225, 250, 275, 300mm

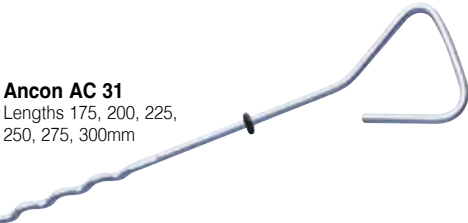

Lengths in **red italics** refer to items available within 24 hours.

Setting tools, resin cartridges, resin guns and mixing nozzles are all available.

Contact us for more details on our range of remedial wall ties and ancillary products.

Ancon Staifix Wire Balloons



A simple and effective way of keeping chimneys and downpipes clear from nesting birds, leaves and other debris.

Available in six standard sizes, wire balloons are manufactured from stainless steel or galvanised steel mesh.

Maintenance-free
and easy
to install

Wire Balloon Size	Stainless Mesh Size	Galvanised Mesh Size
2½"	1"	½"
3"	1"	½"
4"	1"	½"
6"	¾"	¾"
8"	1"	¾"
9"	1"	¾"

Note: Stainless steel balloons are manufactured to order.
Galvanised steel balloons are available ex-stock.

Helical Nails for Warm Roof Construction

Helical nails are a quick and reliable fixing for use in warm roof applications. Unlike traditional nails, they rotate as they are driven in, inducing a self-tapping action and consequently do not split or bounce timbers.

Super-7™ Thor-Helical Nail for Pitched Roofs

Stocked Lengths:

140, 150, 160, 165, 175, 185mm

Note: Other lengths are available in increments of 5mm. We recommend a minimum counter batten thickness of 38mm.



GB Patent No. 2426949

Super-7™ Alignment Tool for Pitched Roofs

European Patent No. 1307303

HeliCalc Calculator

HeliCalc is a free web-based program which calculates the length, density and quantity of Super-7 nails required for a specific project. Visit www.helicalc.co.uk or contact us for more information.



Super-8 Headed Helical Nail for Flat Roofs

Standard Lengths:

145, 170, 195mm

Note: Other lengths are available on request (min. 135mm)



For more information on the above products please refer to the 'Helical Nails for Warm Roof Construction' brochure

Applications

Pitched Roofs

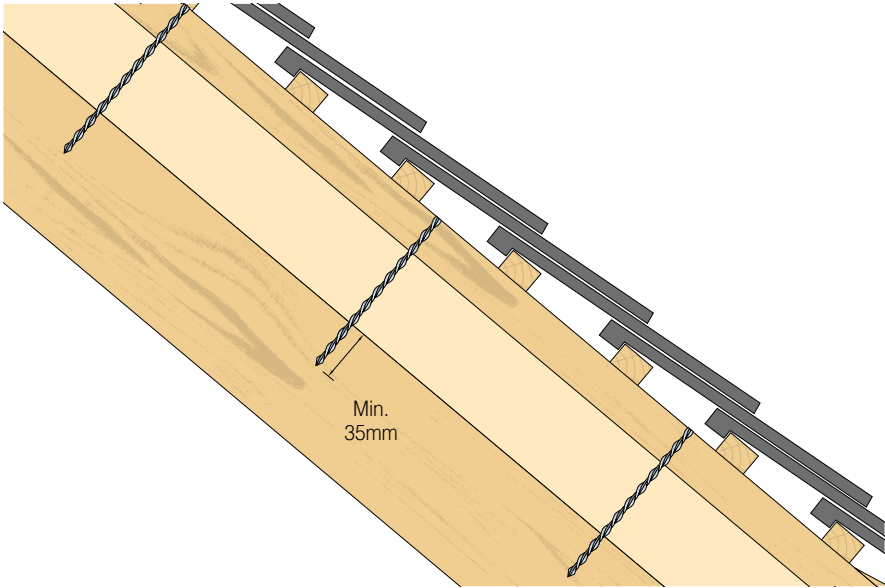

Helical nails fix counterbattens to rafters, without compressing the layer of insulation in-between.

Flat Roofs

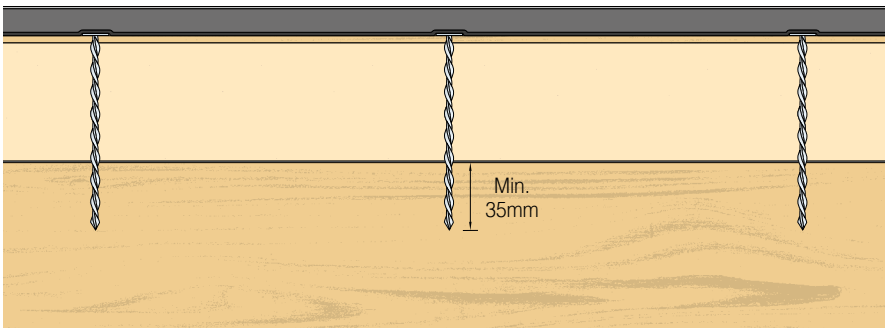

Headed helical nails fix plywood/insulation composite roof panels to joists.

Product Approvals & Certifications

The table below highlights the relevant markings for each of our Ancon Staifix Wall Tie & Restraint Fixings range. Full DoPs can be downloaded from our website at: www.ancon.co.uk/approvals

UKCA Marking

The UKCA (UK Conformity Assessed) marking is the new UK product marking that will be used for goods being placed on the market in Great Britain.

CE UKNI Marking

The UKNI marking is a new conformity marking for products placed on the market in Northern Ireland which will be used on products that have undergone mandatory third-party conformity assessment by a body based in the UK.

CE Marking

For products used in Europe the existing CE mark will still remain. Our DoPs have been updated, please visit www.ancon.co.uk/approvals for the latest version for the products highlighted below.

Product	UK CA	CE UK NI	CE
HRT4	✓	-	✓
RT2	✓	-	✓
ST1	✓	-	✓
SDB 125-300mm	✓	-	✓
SPB 75-300mm	✓	-	✓
PPS 150-300mm	✓	-	✓
PPB 125-225mm	✓	-	✓
SPV 75-300mm	✓	✓	-
PPV 125-225mm	✓	✓	-
Cavity Starter Tie	✓	✓	-
Frame Tie	✓	✓	-
StarterTie	✓	✓	-
STF6 50mm, 75mm, 100mm	✓	✓	-
TJ2 205, 230, 255, 280, 305mm long	✓	✓	-
DT 150-250mm	✓	✓	-
DT 275-300mm	✓	-	✓
SPS 150-300mm	✓	-	✓
SPS CJ 150mm	✓	✓	-
TFMT7 50-150mm cavity	✓	✓	-
TIM6 175, 200, 225, 250mm	✓	✓	-
SDV 125-300mm	✓	✓	-

To download the relevant approvals and certifications visit www.ancon.co.uk/approvals

Worldwide contacts for Leviat:

Australia

Leviat
98 Kurrajong Avenue,
Mount Druitt Sydney, NSW 2770
Tel: +61 - 2 8808 3100
Email: info.au@leviat.com

Austria

Leviat
Leonard-Bernstein-Str. 10
Saturn Tower, 1220 Wien
Tel: +43 - 1 - 259 6770
Email: info.at@leviat.com

Belgium

Leviat
Industrielaan 2
1740 Ternat
Tel: +32 - 2 - 582 29 45
Email: info.be@leviat.com

China

Leviat
Room 601 Tower D, Vantone Centre
No. A6 Chao Yang Men Wai Street
Chaoyang District
Beijing - P.R. China 100020
Tel: +86 - 10 5907 3200
Email: info.cn@leviat.com

Czech Republic

Leviat
Business Center Šafránková
Šafránková 1238/1
155 00 Praha 5
Tel: +420 - 311 - 690 060
Email: info.cz@leviat.com

Finland

Leviat
Vädursgatan 5
412 50 Göteborg / Sweden
Tel: +358 (0)10 6338781
Email: info.fi@leviat.com

France

Leviat
6, Rue de Cabanis
FR 31240 L'Union
Toulouse
Tel: +33 - 5 - 34 25 54 82
Email: info.fr@leviat.com

Germany

Leviat
Liebigstrasse 14
40764 Langenfeld
Tel: +49 - 2173 - 970 - 0
Email: info.de@leviat.com

India

Leviat
309, 3rd Floor, Orion Business Park
Ghodbunder Road, Kapurbawdi,
Thane West, Thane,
Maharashtra 400607
Tel: +91 - 22 2589 2032
Email: info.in@leviat.com

Italy

Leviat
Via F.lli Bronzetti 28
24124 Bergamo
Tel: +39 - 035 - 0760711
Email: info.it@leviat.com

Malaysia

Leviat
28 Jalan Anggerik Mokara 31/59
Kota Kemuning, 40460 Shah Alam
Selangor
Tel: +603 - 5122 4182
Email: info.my@leviat.com

Netherlands

Leviat
Oostermaat 3
7623 CS Borne
Tel: +31 - 74 - 267 14 49
Email: info.nl@leviat.com

New Zealand

Leviat
2/19 Nuttall Drive, Hillsborough,
Christchurch 8022
Tel: +64 - 3 376 5205
Email: info.nz@leviat.com

Norway

Leviat
Vestre Svanholmen 5
4313 Sandnes
Tel: +47 - 51 82 34 00
Email: info.no@leviat.com

Philippines

Leviat
2933 Regus, Joy Nostalq,
ADB Avenue
Ortigas Center
Pasig City
Tel: +63 - 2 7957 6381
Email: info.ph@leviat.com

Poland

Leviat
Ul. Obornicka 287
60-691 Poznan
Tel: +48 - 61 - 622 14 14
Email: info.pl@leviat.com

Singapore

Leviat
14 Benoi Crescent
Singapore 629977
Tel: +65 - 6266 6802
Email: info.sg@leviat.com

Spain

Leviat
Polígono Industrial Santa Ana
c/ Ignacio Zuloaga, 20
28522 Rivas-Vaciamadrid
Tel: +34 - 91 632 18 40
Email: info.es@leviat.com

Sweden

Leviat
Vädursgatan 5
412 50 Göteborg
Tel: +46 - 31 - 98 58 00
Email: info.se@leviat.com

Switzerland

Leviat
Grenzstrasse 24
3250 Lyss
Tel: +41 - 31 750 3030
Email: info.ch@leviat.com

United Arab Emirates

Leviat
RA08 TB02, PO Box 17225
JAFZA, Jebel Ali, Dubai
Tel: +971 (0)4 883 4346
Email: info.ae@leviat.com

United Kingdom

Leviat
President Way, President Park,
Sheffield, S4 7UR
Tel: +44 - 114 275 5224
Email: info.uk@leviat.com

United States of America

Leviat
6467 S Falkenburg Rd.
Riverview, FL 33578
Tel: (800) 423-9140
Email: info.us@leviat.us

For countries not listed

Email: info@leviat.com

Leviat.com

Notes regarding this catalogue

© Protected by copyright. The construction applications and details provided in this publication are indicative only. In every case, project working details should be entrusted to appropriately qualified and experienced persons. Whilst every care has been exercised in the preparation of this publication to ensure that any advice, recommendations or information is accurate, no liability or responsibility of any kind is accepted by Leviat for inaccuracies or printing errors. Technical and design changes are reserved. With a policy of continuous product development, Leviat reserves the right to modify product design and specification at any time.



For more information on these products, contact:

Leviat

President Way
President Park
Sheffield, S4 7UR
United Kingdom

Tel: +44 (0) 114 275 5224

Fax: +44 (0) 114 276 8543

Email: info.ancon.uk@leviat.com

For sales enquiries:

Email: sales.ancon.uk@leviat.com

For technical enquiries:

Email: tech.ancon.uk@leviat.com

Ancon.co.uk

Leviat.com/gb-en

Notes regarding this catalogue

© Protected by copyright. The construction applications and details provided in this publication are indicative only. In every case, project working details should be entrusted to appropriately qualified and experienced persons. Whilst every care has been exercised in the preparation of this publication to ensure that any advice, recommendations or information is accurate, no liability or responsibility of any kind is accepted by Leviat for inaccuracies or printing errors. Technical and design changes are reserved. With a policy of continuous product development, Leviat reserves the right to modify product design and specification at any time.

Imagine. Model. Make.

Leviat.com