

NEXUS[®] BRICK-FACED LINTEL SYSTEMS INSTALLATION GUIDE

Brick-Faced Lintels

NEXUS lintels are designed as a lightweight one-piece system which can be simply lifted into place.

STEP 1

Raise the inner and outer leaves simultaneously to avoid excessive eccentricity of loading, with a maximum height difference of 225mm.

Masonry should be laid on a full mortar bed and all perpendicular joints should be fully filled.

Allow the mortar to cure before applying floor or roof loads.



STEP 2

Lintels must be suitably propped during construction at approximately 1 metre centres. On small openings, a central prop can be used. A board should be used between lintel and prop to protect the finished surface and spread the load evenly.



STEP 3

Lintels should be installed with at least 150mm end bearing and be fully bedded on bricklaying mortar.

Ensure lintel is level along the length and width.

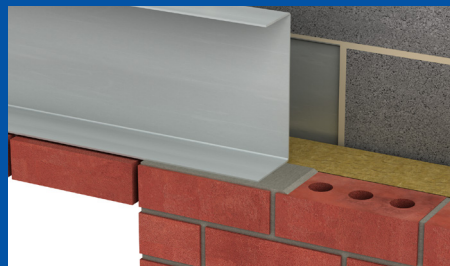

STEP 4

The NHBC, PD6697 recommends a damp-proof course (DPC) or cavity tray is installed over all openings in external cavity walls.



STEP 5

Weep-holes should be provided in the outer leaf above the lintel to drain moisture from the cavity. A minimum of two weep-holes should be provided per lintel. For fair-faced masonry, weep-holes should be provided at centres not greater than 450mm.



STEP 6

Precautions must be taken to prevent mortar dropping through the cavity onto the lintel and obstructing the weep-holes.

STEP 7

Brick slips should be pointed using the same mortar as the rest of the brickwork, but only after the full load has been applied to the lintel.

