

Installation Guide

Teplo-Channel Basalt Fibre Wall Ties

The Ancon Teplo-Channel tie range uses an innovative combination of basalt fibres set in a resin matrix to provide a low thermal conductivity wall tie for use with our popular Omega 21/18, 25/14 and 28/15 channels. Profiled stainless steel heads allow for unlimited adjustment along the length of the channel and moulded safety ends ensure a firm bond with the outer leaf.

The unique ribbed shank acts as a drip to prevent water crossing the cavity. Where insulation needs to be retained, the black Ancon Teplo-Clip can be used.

The Teplo-Channel range has been independently tested and is BBA approved.

Installation Guidance

Channel wall ties are important to the stability of masonry and failure to install them correctly may lead to damp penetration, cracking or even the collapse of walls.

The channel end of the tie should be inserted between the lips of the channel and rotated into place so that the tie engages with both channel lips. Installed ties should be clear of mortar droppings to allow the drip function to perform correctly and prevent water from crossing to the inner leaf.

The moulded safety end of the tie should be pressed down in fresh mortar on the outer leaf with a minimum embedment of 55mm. Wall ties should be surrounded by mortar and not simply positioned directly onto masonry with mortar placed around them.

Ideally, channel ties should be installed with a slight fall to the outer leaf, not towards the inner leaf as this could provide a path for moisture to cross the cavity.

Note: for information regarding installation of cast-in or surface fixed channels, please refer to our Channel installation guide.

Separate installation guidance and literature is also available for the **Ancon 25/14 Restraint System**. Please contact the Leviat Technical team for further information.

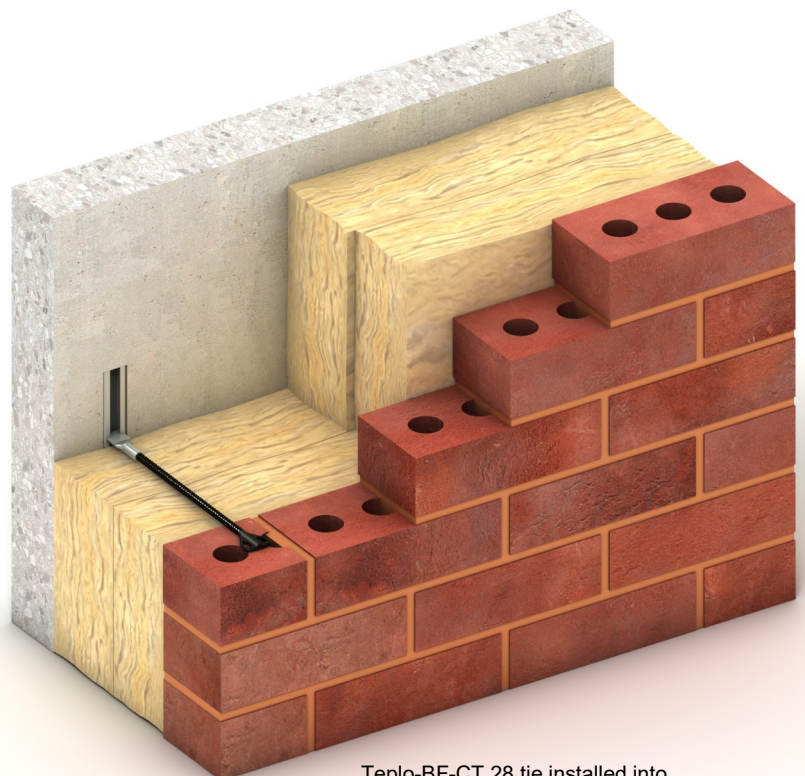
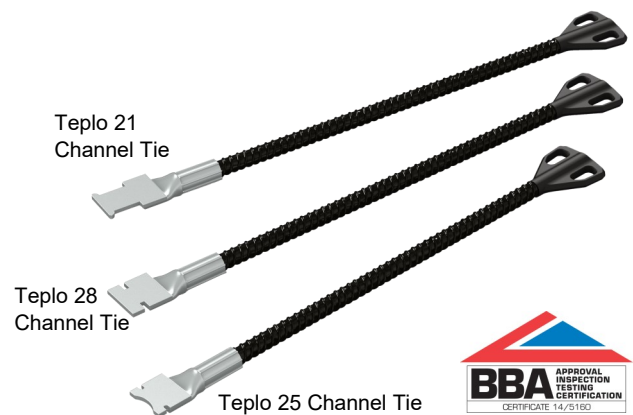

Teplo-BF-CT 28 tie installed into 28/15 cast-in channel

Recommended Fixing Centres

Ancon Teplo-Channel ties are suitable for cavities from 70mm to 344mm. The ties achieve Type 2 or Type 3 performance to PD 6697:2019 when installed at a standard spacing of 2.5 ties per square metre. Recommended tie spacing is given in the table based on channels installed at typical 600mm horizontal centres.

Ancon Teplo-Channel Tie Product Codes and Recommended Fixing Centres

Product Code	PD6697 Tie Type	Cavity Range (mm)	Tie Length (mm)	Recommended Spacing (mm)	
				Type 1*	Type 2
TEPLO-BF-CT 21 -150	2	70-94	150	600 X 375	600 X 450
TEPLO-BF-CT 21 -175	2	95-119	175	600 X 375	600 X 450
TEPLO-BF-CT 21 -200	2	120-144	200	600 X 375	600 X 450
TEPLO-BF-CT 21 -225	2	145-169	225	600 X 375	600 X 450
TEPLO-BF-CT 21 - 250	2	170-194	250	600 X 375	600 X 450
TEPLO-BF-CT 21 - 275	2	195-219	275	600 X 375	600 X 450
TEPLO-BF-CT 21 - 300	2	220-244	300	600 X 375	600 X 450
TEPLO-BF-CT 21 - 325	3	245-269	325	600 X 225	600 X 450
TEPLO-BF-CT 21 - 350	3	270-294	350	600 X 225	600 X 450
TEPLO-BF-CT 21 - 375	3	295-319	375	600 X225	600 X 450
TEPLO-BF-CT 25 - 150	2	85-109	150	600 X 300	600 X 450
TEPLO-BF-CT 25 - 175	2	110-134	175	600 X 300	600 X 450
TEPLO-BF-CT 25 - 200	2	135-159	200	600 X 300	600 X 450
TEPLO-BF-CT 25 - 225	2	160-184	225	600 X 300	600 X 450
TEPLO-BF-CT 25 - 250	2	185-209	250	600 X 300	600 X 450
TEPLO-BF-CT 25 - 275	2	210-234	275	600 X 300	600 X 450
TEPLO-BF-CT 25 - 300	3	235-259	300	600 X 225	600 X 450
TEPLO-BF-CT 25 - 325	3	260-284	325	600 X 225	600 X 450
TEPLO-BF-CT 25 - 350	3	285-309	350	600 X 225	600 X 450
TEPLO-BF-CT 25 - 375	3	310-334	375	600 X 225	600 X 450
TEPLO-BF-CT 28 - 150	2	70-94	150	600 X 375	600 X 450
TEPLO-BF-CT 28 - 175	2	95-119	175	600 X 375	600 X 450
TEPLO-BF-CT 28 - 200	2	120-144	200	600 X 375	600 X 450
TEPLO-BF-CT 28 - 225	2	145-169	225	600 X 375	600 X 450
TEPLO-BF-CT 28 - 250	2	170-194	250	600 X 375	600 X 450
TEPLO-BF-CT 28 - 275	2	195-219	275	600 X 375	600 X 450
TEPLO-BF-CT 28 - 300	2	220-244	300	600 X 375	600 X 450
TEPLO-BF-CT 28 - 325	3	245-269	325	600 X 225	600 X 450
TEPLO-BF-CT 28 - 350	3	270-294	350	600 X 225	600 X 450
TEPLO-BF-CT 28 - 375	3	295-319	375	600 X 225	600 X 450
TEPLO-BF-CT 28 - 400	3	320-344	400	600 X 225	600 X 450

Note: Centres shown achieve equivalent tie type performances to PD 6697:2019 Table 12. Refer to our Wall Ties and Restraint Fixings brochure for further information. *Type 1 based on M2 mortar and 2500N Tensile/ 2000N Compressive capacity (PD 6697:2019). Cavity range values refer to cast-in applications for 21 and 28 ends. For surface fixed 28/15 applications, cavity values should be increased by 15mm. Cavity range values given for 25 ends refer to channels fixed to front of insulation i.e. remaining clear cavity.

The Construction applications and details provided in this guide are indicative only. In every case installation should be entrusted to appropriately qualified and experienced persons. Normal handling precautions should be taken to avoid physical injury. The company cannot be held responsible for any injury as a result of using our products, unless such injury arises as a result of our negligence.

© Protected by copyright