

# Tools for Ancon Helical Fixings

## Ancon TJ2 Thin-Joint Wall Ties

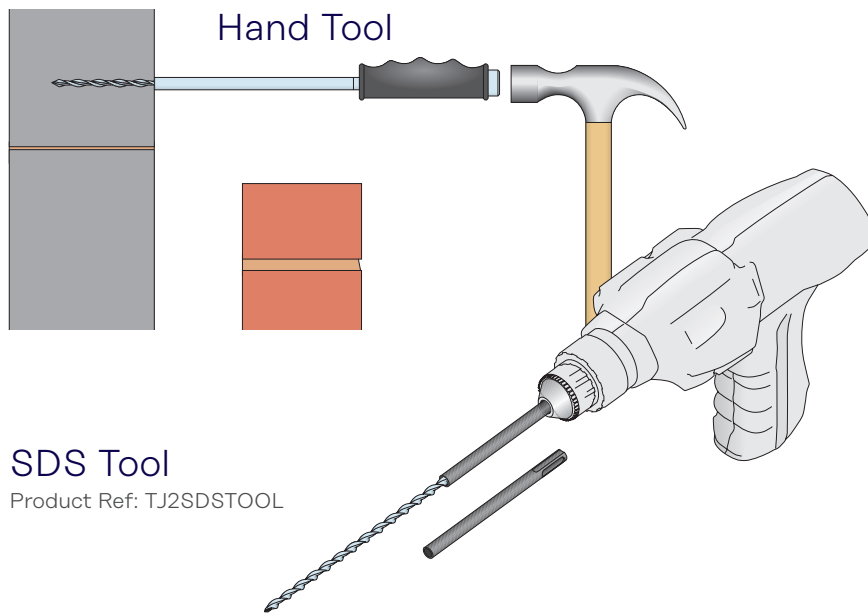

**SDS Tool**  
Product Ref: TJ2SDSTOOL

Product Ref: TJ250TOOL  
for Tie Length 205mm and  
50mm cavity



Product Ref: TJ275TOOL  
for Tie Length 230mm and  
75mm cavity



Product Ref: TJ2100TOOL  
for Tie Length 255mm and  
100mm cavity



Product Ref: TJ2125TOOL  
for Tie Length 280mm and  
125mm cavity



Product Ref: TJ2150TOOL  
for Tie Length 305mm and  
150mm cavity



## Ancon TIM6 Timber Frame Wall Ties

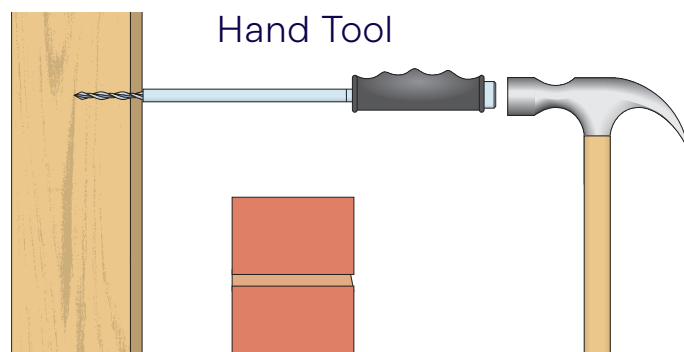

Product Ref: TIM6175TOOL  
for Tie Length 175mm and  
50-75mm cavity



Product Ref: TIM6200TOOL  
for Tie Length 200mm and  
76-100mm cavity



Product Ref: TIM6225TOOL  
for Tie Length 225mm and  
101-125mm cavity



Product Ref: TIM6250TOOL  
for Tie Length 250mm and  
126-150mm cavity



# Ancon Super 7 Warm Roof Batten Fixings

## Alignment Tool

Product Ref: STH UNI TOOL

## Hand Tool

Product Ref: WRBFSPTOOL

## SDS Drive Tool

Product Ref: WRBFSDSTOOL



Leviat recommends use of the alignment tool to ensure the nail is centred on the counterbatten and installed perpendicularly to the rafter. It can also be used in conjunction with the hand or SDS drive tools if required.

# Ancon ISF18A Insulated Plasterboard Nails

## Ancon SDS Tools

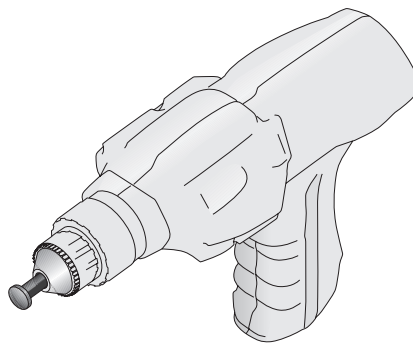
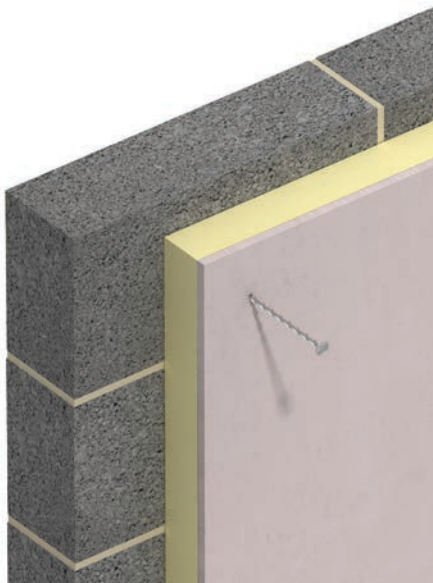

Professional SDS Adaptor set  
ISF-18A-SDS-PRO



Standard SDS Adaptor  
Product Ref: ISF-18S-SDSTOOL