

Design Sheet - Ancon KSN Anchor - Wall to Slab Connections

Please provide: contact details; project details; design conditions;

1. Contact Details

Contact name

Company

Address

.....

Tel.

.....

Email

Project name and town

.....

The following design assumptions are made unless advised otherwise:

- Reinforcement yield stress = 500N/mm²
- The wall extends at least 3 x the wall thickness, both above and below the slab
- Standard 33mm timber anchor carrier used

Comments

2. Please enter values in all boxes for top anchor specification

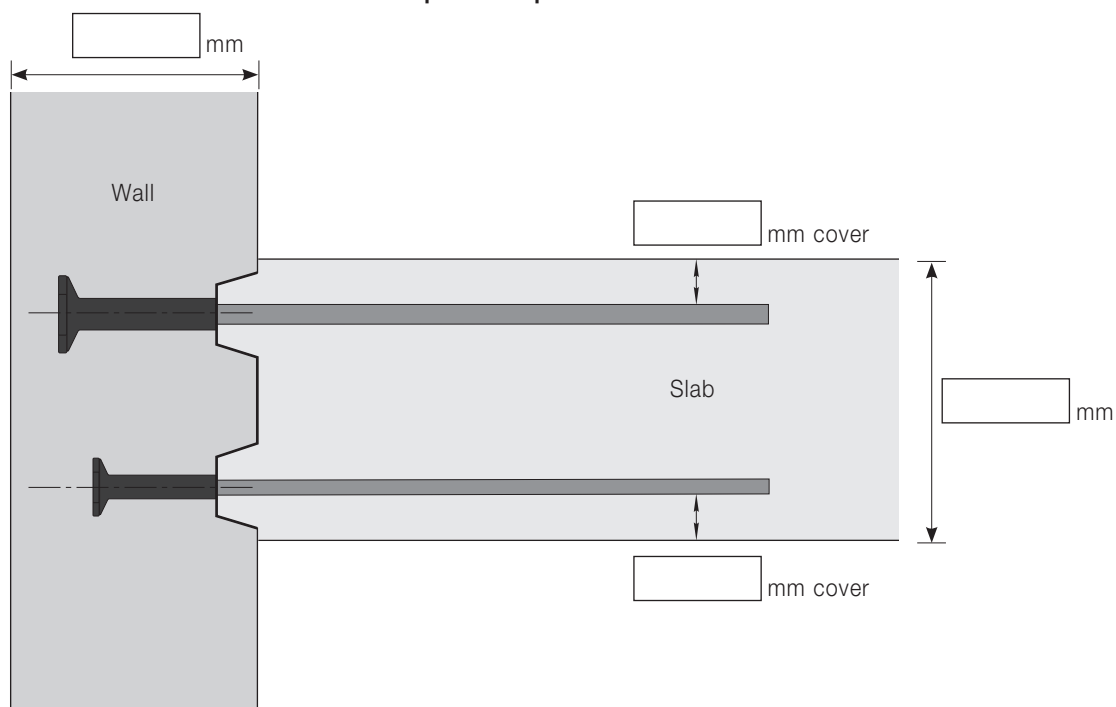

3. Design Conditions

Concrete grade C /.....

Horizontal spacing of reinforcement in top of slabmm

Moment applied at joint M_{Ed} kN.m/m ULS

We can also specify bottom anchors to provide the slab bottom reinforcement anchorage according to EC2.

Slab bottom reinforcement anchorage, joint vertical shear and horizontal tie checks are carried out.

Please provide the following information if this service is required:

Slab support condition simply supported / flexural restraint (select one)

Slab bottom reinforcement provided in spandia @ centres

Vertical shear at joint V_{Ed} kN/m ULS

Horizontal Tie Force at joint TkN/m ULS

Email to reinforcement.uk@leviat.com

Leviat, President Way, President Park, Sheffield, S4 7UR, UK.

Tel: +44 (0) 114 275 5224, Web: Ancon.co.uk | Leviat.com

