

## Installation Guide

# Ancon Two-Part Wall Tie

Cavities over 150mm which necessitate long wall ties can be difficult to balance and keep horizontal when built into the inner leaf. Two-Part Ties can be used to eliminate these issues. The Ancon Two-Part Tie has one section built into the inner leaf and the second section is installed as the outer leaf is built.

### Wall Tie Lengths & Embedment Depth

The Ancon Two-Part Tie requires an embedment depth of 75mm in each leaf. The inner section is usually manufactured in a length of 170mm with variation in the cavity width being accommodated by the length of the outer section.

Where insulation thickness is in excess of 60mm, the inner section should be longer than the standard 170mm to ensure the connection between the two parts is made in the open cavity.

### Recommended Length of Inner Section

Insulation Thickness (mm)	Inner Section Length (mm)
0-50	170
60 +	Insulation thickness +110

### Installation Procedure

Users should check wall tie length and density with the information above and overleaf prior to installation.

Wall ties should be pressed down in, and then surrounded by, fresh mortar. They should not simply be positioned directly onto the masonry with mortar placed around them or pushed into a constructed joint.

The inner section is built into the first masonry leaf ensuring a 75mm embedment depth. Insulation should be held back using Ancon insulation retaining clips referenced 'TJ Clip'.

As work on the second masonry leaf progresses, the outer tie section is fixed into the inner section as shown below.

### Installation

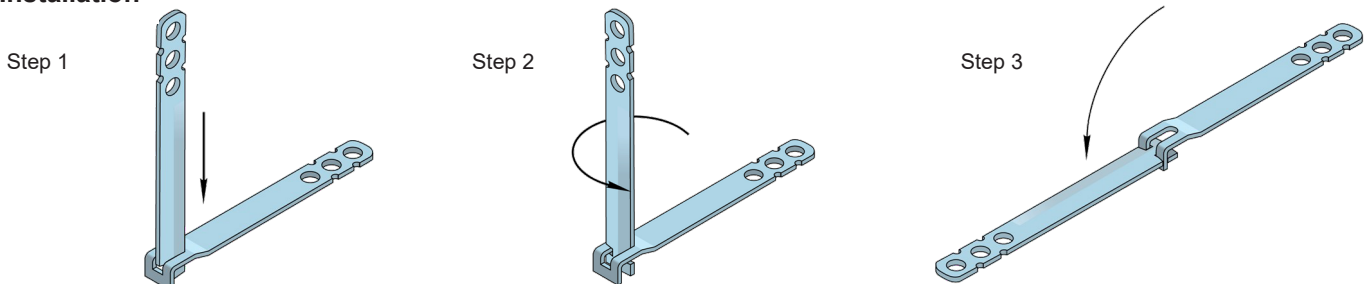

### Ancon Two-Part Tie

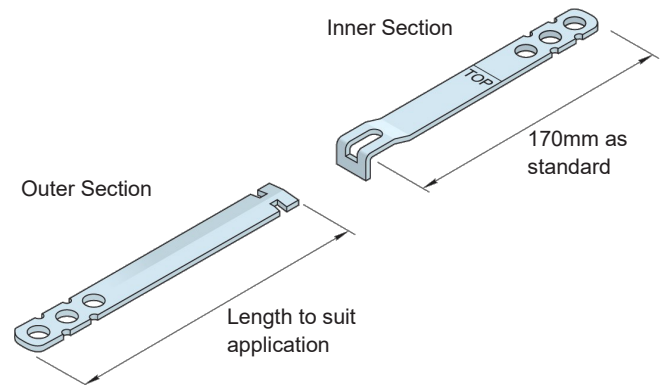

### Embedment Depths

