

## Installation Guide

**Ancon HIT Hammer-in Tie****For Fixing Brickwork to an Existing Inner Leaf**

Ideally, brickwork should be kept one course clear during installation of the ties. Ties should be installed level, or with a slight fall to the outer leaf and always bedded on, and then surrounded by, fresh mortar.

1. Drill a 6mm diameter hole 50mm deep, into the inner leaf and insert the nylon plug into the hole.
2. Insert the plain end of the tie into the tool, as far as it reaches leaving the 45mm thread exposed. Locate the tie in the plug.
3. Hammer the tool until the tie is no longer visible and the tool is flush with the inner leaf. Remove the tool and push an 'O' ring on to the tie to a central position in the open cavity. Alternatively, the 'O' ring can be fitted after stage 5 below.
4. Re-insert the tie in the tool leaving enough tie exposed to allow for adequate embedment in the outer leaf of brickwork. Leviat recommends an embedment depth between 50-65mm.
5. Supporting the tie by hand in the open cavity, bend parallel to the brickwork, ensuring an angle of 85-90° is achieved.
6. Remove the tool and build the tie into the bed joint of the outer leaf of brickwork.

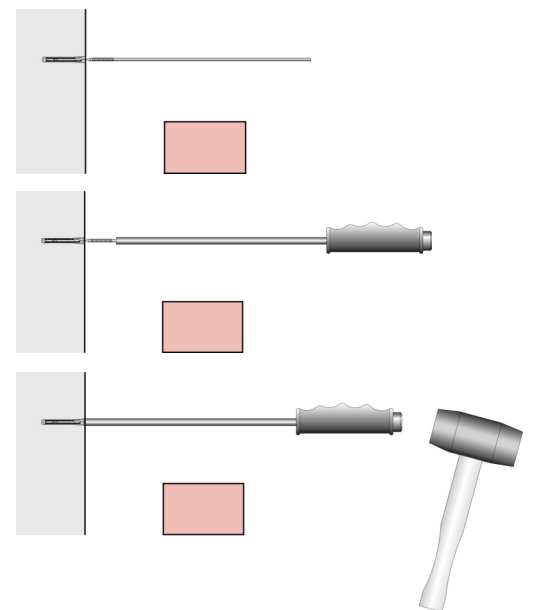

**50-65mm Embedment Depth**

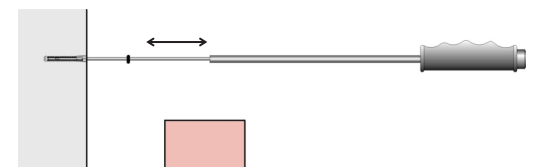
**Installation Tool & Nylon Plug**

The installation tool has been specially designed with hardened steel located at both the tip, and base, providing extra strength where required. **The Ancon HIT must be used with the plug supplied.**

**Note:** The Ancon HIT can be used with high density blockwork of 7N/mm<sup>2</sup> and above.

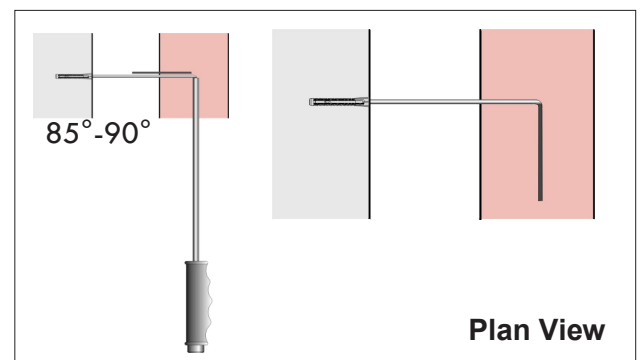
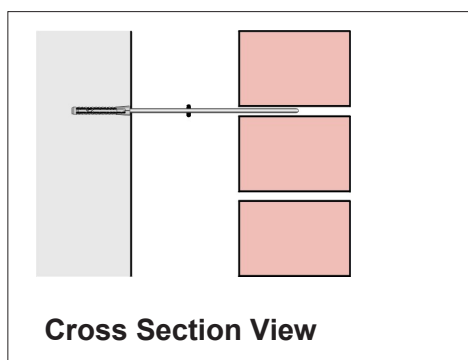

The Construction applications and details provided in this guide are indicative only. In every case installation should be entrusted to appropriately qualified and experienced persons. Normal handling precautions should be taken to avoid physical injury. The company cannot be held responsible for any injury as a result of using our products, unless such injury arises as a result of our negligence.

© Protected by copyright