

The logo for Prefix Gauge Systems features the words "Prefix Gauge Systems" in a blue, sans-serif font. The text is centered within a circular orange graphic that consists of a vertical line, a horizontal line, and a circle, resembling a crosshair or a target symbol.

Prefix
Gauge
Systems

Partnered with
Ancon[®]
BUILDING PRODUCTS

'SUPPLY & FIX'

Specialist Subcontractor

Prefix Gauge Systems provides a professional fixing service for all brickwork support and restraint systems

No Waste

You only pay for the items used

Inclusive Costs

Cost per item includes setting out, all fixings and secondary fixings ie bolts / screws (isolation material and debonding sleeves where required), power and tools

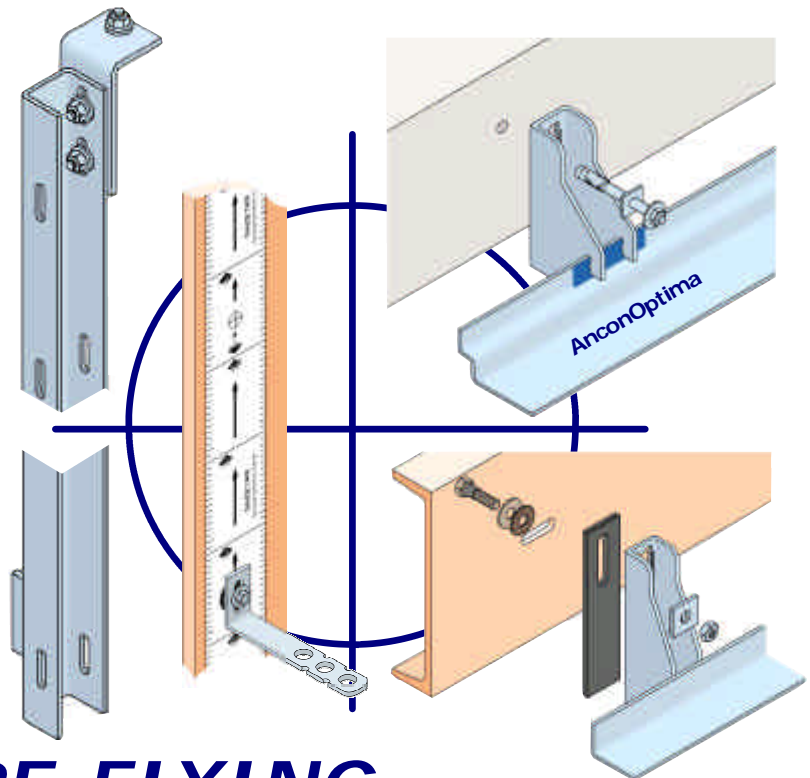

PRE-FIXING

Support Angles and Restraints :

Speeds the rate of construction

Bricklayers are allowed to concentrate on their trade, with less supervision, and can work on more than one elevation at a time

Provides a visual check of correct installation

Site engineers can approve the layout and ensure all fixings are securely fastened prior to the commencement of brickwork

Improves the quality of the external brickwork

Restraints are fixed to an accurate brickwork gauge using PGS patented tape. This gauge is easily maintained by the bricklayers

The Ultimate Supply & Fix Service

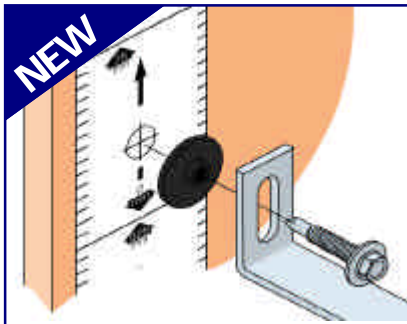

ISO-TW **Isolation Washer**

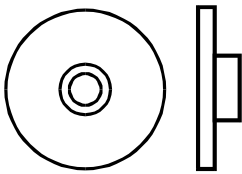

The new ISO-TW was developed by PGS to prevent bi-metallic corrosion by separating stainless steel frame cramps from mild steel frames.

Unlike other isolation methods, the ISO-TW allows Ancon frame cramps referenced __ V (eg SPV) to be vertically adjusted after fixing, within the 30mm range of the slot.

This adjustment is invaluable to bricklayers.

The ISO-TW is an innovative solution that enables the location of pre-fixed frame cramps to be easily adjusted to suit the exact location of mortar joints.

Accurate Brickwork Gauge — Guaranteed

'Gauge Tape' is patented by PGS. This tape adheres directly to the structural frame and ensures restraints are fixed to an accurate gauge. Use of this system can speed construction and improve the quality of your brickwork.

Experienced Installers

We have provided this service for many years. All our contracts are undertaken by highly skilled operatives with experience of both steel and concrete frames.

No wastage

You only pay for the fixings used.

Standard Cost per Item

You pay a standard rate per item that includes:

- Setting out to your specifications
- Accurate installation
- Supply of all fixings including bolts / screws, debonding sleeves, isolation material etc
- Labour, power and tools

Partnered with Ancon

Our partnership with Ancon Building Products ensures clients of the best attention from design to installation. PGS combines Ancon's design and manufacturing excellence with our installation experience and efficiency to provide the ultimate service. We are committed to value engineering and will ensure the most cost-effective fixing solution is designed.

Large Stocks of Fixings

We carry considerable stocks of many standard restraint fixings. Our partnership with Ancon enables bespoke systems to be obtained promptly.



Prefix Gauge Systems Ltd
Unit 5A, 1 Ramsden Road, Rotherwas, Hereford HR2 6NP

Tel: 01432 270943

Fax: 01432 267646