

Installation Guide

Ancon KSN Anchor Box

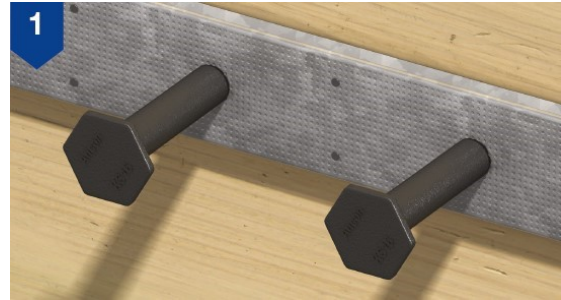

Nail the KSN Anchor Box to the formwork. The wall reinforcement is installed to which the anchors are tied. The concrete is cast and once it reaches sufficient strength, the formwork is removed to reveal the steel cover.



When a connection is required, the cover is removed and the bolts which held the Anchors to the box prior to installation are removed to reveal the threads.



The Bartec Plus parallel-threaded continuation bars are inserted into the KSN Anchors and hand-tightened until fully locked using a wrench. Lap and fix the slab reinforcement and pour the concrete to complete the installation.

The Construction applications and details provided in this guide are indicative only. In every case installation should be entrusted to appropriately qualified and experienced persons. Normal handling precautions should be taken to avoid physical injury. The company cannot be held responsible for any injury as a result of using our products, unless such injury arises as a result of our negligence.

© Protected by copyright