

Installation Guide

Ancon Isotec Concrete-to-Concrete Balcony Connector

Ancon Isotec balcony connectors are manufactured as a non-deformable cage offering high rigidity and dimensional stability. Prior to installation, ensure all Isotec elements have not been damaged during transit or site handling and that they correspond to the project specification.

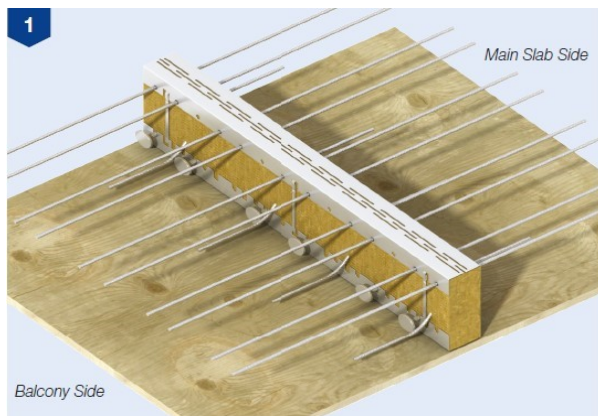
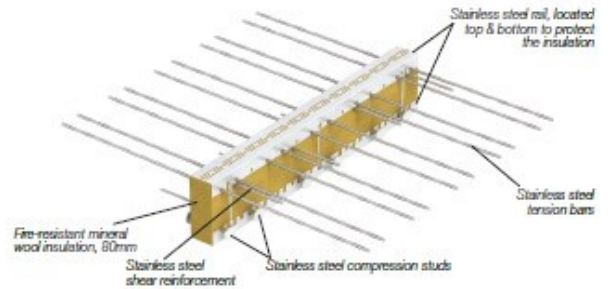

Place the Isotec system on the formwork in line with the project drawings, ensuring all Isotec elements are positioned and orientated as indicated on the product label.

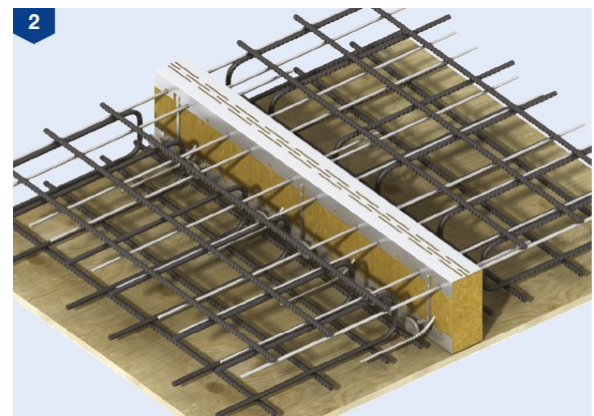

Position all necessary local and main reinforcement. Secure each Isotec unit to the slab reinforcement. Any gaps between Isotec elements must be filled with equivalent insulating material.



Contact us immediately if you have any questions regarding correct installation.

Concrete should be poured adjacent to the Isotec system and simultaneously to either side to avoid any displacement.

Precast Applications

If Isotec elements are used in precast balconies, lifting systems must be positioned within the gaps between Isotec elements. Ensure the compression studs do not apply pressure on an internal structure already in position.



Scan the code to watch an installation video.

The Construction applications and details provided in this guide are indicative only. In every case installation should be entrusted to appropriately qualified and experienced persons. Normal handling precautions should be taken to avoid physical injury. The company cannot be held responsible for any injury as a result of using our products, unless such injury arises as a result of our negligence.

© Protected by copyright