

Installation Guide

Capsule (Bonded) Anchors

Type FCS RG

Notes

Anchor installation to be carried out under the supervision of the person responsible for technical matters on site.

Use of the anchor only as supplied by us without exchange of any components.

Checks must be carried out prior to the installation of the anchor to ensure the placed concrete matches the design parameters i.e. concrete strength, cracked/non-cracked.

Checks must be carried out to ensure the concrete is well compacted and free from significant voids.

In the case of aborted holes, these must be filled with an appropriate non-shrink grout of equal or greater compressive strength to the surrounding concrete.

Drilling is to be by **hammer drill only** – Diamond drilling is not permitted.

Exposed threads to be protected by the use of tape.

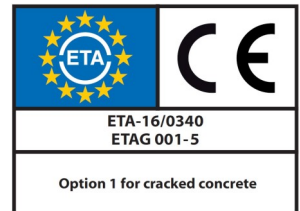

Table 1

Anchor Reference	FCS	FCS	FCS	FCS	FCS
	RGM08/R-110	RGM10/R-130	RGM12R-160	RGM16/R-190	RGM20/R-260
Overall Length (mm)	110	130	160	190	260
Hole Dia. in Concrete (mm)	10	12	14	18	25
Drill Depth* (mm)	80	90	110	125	170
Hole Dia. in Fixture (mm)	9	11	14	18	22
Embedment* (mm)	80	90	110	125	170
Tightening Torque (Nm) T_{inst}	10	20	40	60	120
Max. Fixing Thickness (mm)	10	16	21	32	52

*Typical drill hole and embedment depths

Table 2

Concrete Temperature	Min. Curing Time
-5°C to ± 0°C	4 hr
≥0°C to + 10°C	45 mins
≥ + 10°C to + 20°C	20 mins
≥ + 20°C	10 mins

*For wet concrete and flooded holes the curing time must be doubled

Installation Procedure

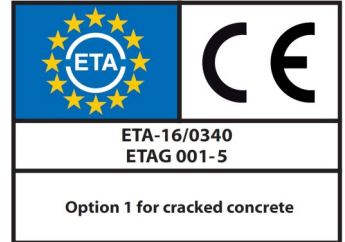

1. Drill a hole of appropriate diameter and depth. See table 1 for reference.

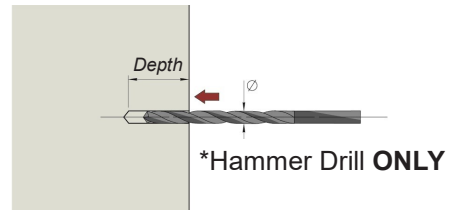

2. Clean hole using a minimum of four times blowing operations with a manual blow out tool.

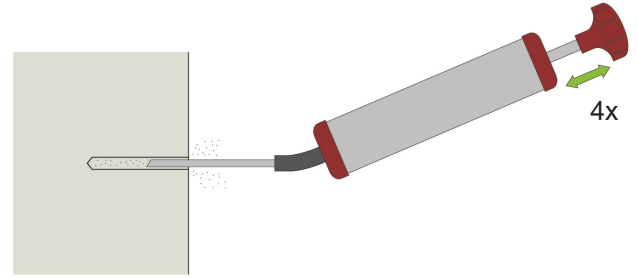

3. Put the mortar capsule RM into the cleaned drill hole.

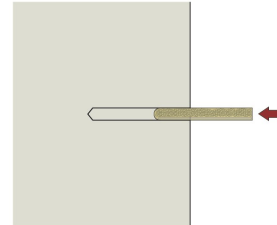

4. Attach the anchor rod to an electric drill and, using impact and rotation, insert into the hole. Switch off immediately when the drill hole base is reached.

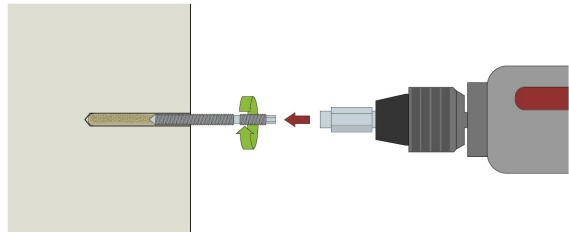

5. Do not touch the anchor until the appropriate cure time is reached. See Table 2.

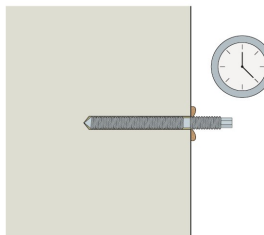

6. Set the fixing with the appropriate torque. See Table 1.

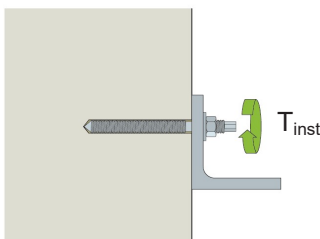

The Construction applications and details provided in this guide are indicative only. In every case installation should be entrusted to appropriately qualified and experienced persons. Normal handling precautions should be taken to avoid physical injury. The company cannot be held responsible for any injury as a result of using our products, unless such injury arises as a result of our negligence.

© Protected by copyright