

# Design Sheet - Ancon KSN Anchor - Wall to Slab Connections

Please provide: contact details; project details; design conditions;

## 1. Contact Details

Contact name .....

Company .....

Address .....

.....

.....

Tel. ....

.....

Email .....

Project name and town .....

.....

**The following design assumptions are made unless advised otherwise:**

- Reinforcement yield stress = 500N/mm<sup>2</sup>
- The wall extends at least 3 x the wall thickness, both above and below the slab
- Standard 33mm timber anchor carrier used

Comments

## 2. Please enter values in all boxes for top anchor specification

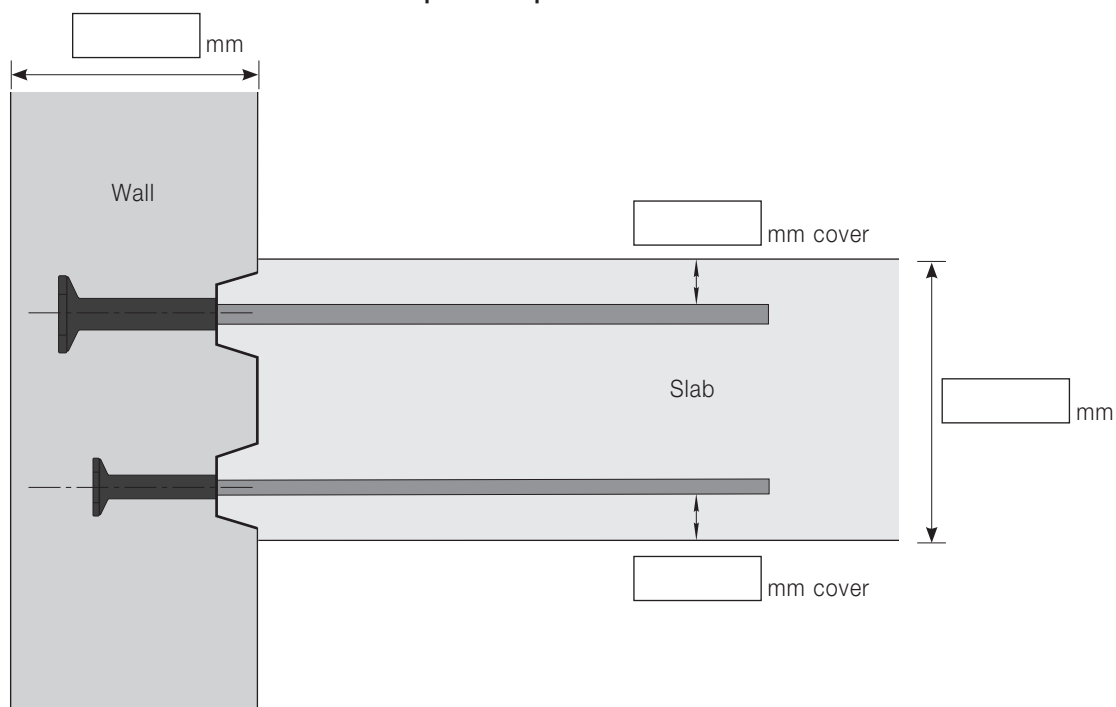

## 3. Design Conditions

Concrete grade C ..... /.....

Horizontal spacing of reinforcement in top of slab .....mm

Moment applied at joint  $M_{Ed}$  .....kN.m/m ULS

**We can also specify bottom anchors to provide the slab bottom reinforcement anchorage according to EC2.**

**Slab bottom reinforcement anchorage, joint vertical shear and horizontal tie checks are carried out.**

**Please provide the following information if this service is required:**

Slab support condition simply supported / flexural restraint (select one)

Slab bottom reinforcement provided in span .....dia @ ..... centres

Vertical shear at joint  $V_{Ed}$  .....kN/m ULS

Horizontal Tie Force at joint T .....kN/m ULS

Email to [reinforcement.uk@leviat.com](mailto:reinforcement.uk@leviat.com)

Leviat, President Way, President Park, Sheffield, S4 7UR, UK.

Tel: +44 (0) 114 238 5224, Web: [Ancon.co.uk](http://Ancon.co.uk) | [Leviat.com](http://Leviat.com)

